



111a Havelock Road, Luton, Bedfordshire, LU2 7PR
£1,200 Per month



- EXCLUSIVE TO PR PROPERTY
- Private garden ideal for relaxation or entertaining
- Available APRIL 2026
- GARAGE AT REAR NOT INCLUDED

- Two bedrooms providing versatile living space
- Close proximity to Luton town centre with shops and amenities
- Gas CH

- Ground floor convenience for ease of access
- Easy access to the local train station for commuting
- Must be viewed

**** Exclusive to PR Property **** This well-positioned two-bedroom ground floor apartment on Havelock Road, Luton, offers a comfortable living space ideal for those wanting convenient access to the town center. Available APRIL 2026, it benefits from its own private garden, providing a peaceful outdoor retreat. The proximity to the train station makes commuting easy and efficient. Perfect for professionals or small families seeking practicality alongside outdoor space, this property promises a blend of convenience with privacy. GARAGE IN REAR GARDEN NOT INCLUDED.

LIVING ROOM 12'1" X 12'0" MAX (3.68 X 3.65 MAX)

KITCHEN 11'7" X 10'10" (3.53 X 3.30)

BEDROOM 1 10'9" X 10'7" (3.28 X 3.23)

BEDROOM 2 12'10" MAX X 10'10" (3.91 MAX X 3.29)

BATHROOM

WC

REAR GARDEN

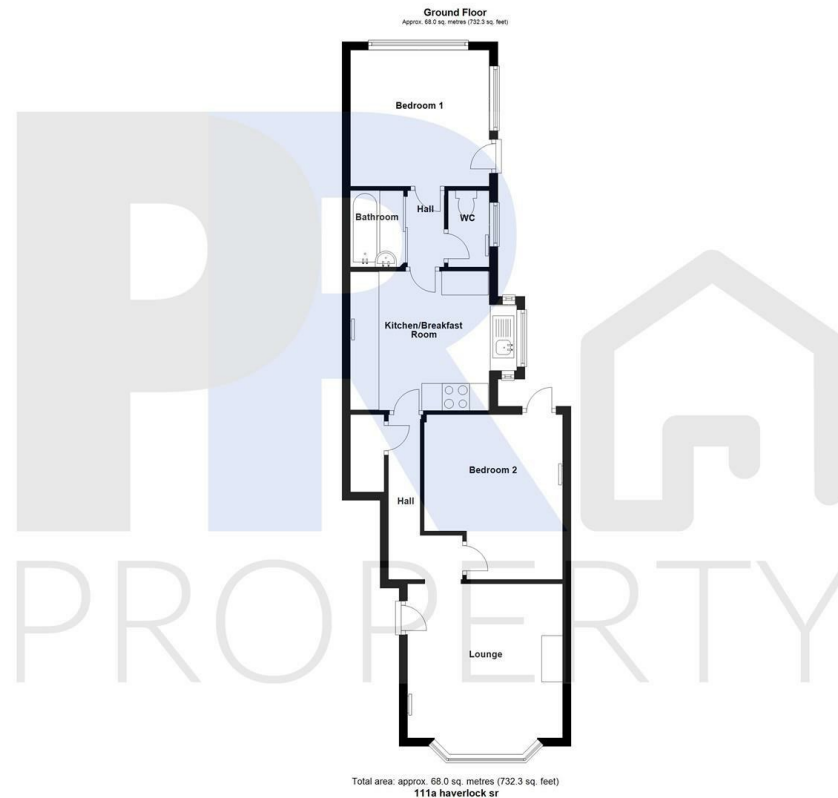

Energy Efficiency Rating		Current	Potential
Very energy efficient - lower running costs			
(92 plus) A			
(81-91) B			
(69-80) C		80	80
(55-68) D			
(39-54) E			
(21-38) F			
(1-20) G			
Not energy efficient - higher running costs			
England & Wales		EU Directive 2002/91/EC	